

# ***RADIAL ENGINES***



---

# ENGINEERING EXCELLENCE

*"The quality of Rotec  
engines and parts are  
superior to all"*

*-Bill Pieper  
Aeronautical engineer  
FAA Engineering Representative*





Rotec Aerosport has manufactured dependable radial engines since 1999. All Rotec engines exhibit the craftsmanship of a bygone era and are sure to please even the most discerning recreational pilot and homebuilder alike. With now 20 years production and over 2,500 units sold worldwide, Rotec radials have become the benchmark when it comes to quality and design. Countless award winning, WW1, Classic and Vintage aircraft can once again take to the skies as a result of Rotec radial power.



---

# AEROPLANES

## BUILT FOR RADIAL POWER



HISTORICAL PLANES



SPORT PLANES



MILITARY PLANES

---



---

There are countless examples of aircraft using Rotec radial power. Customers spanning the globe enjoy the nostalgic pleasure and adventure that every start-up brings. Able to power a huge variety of aeroplanes and kits, why settle for second best when Rotec radial power is within your reach?



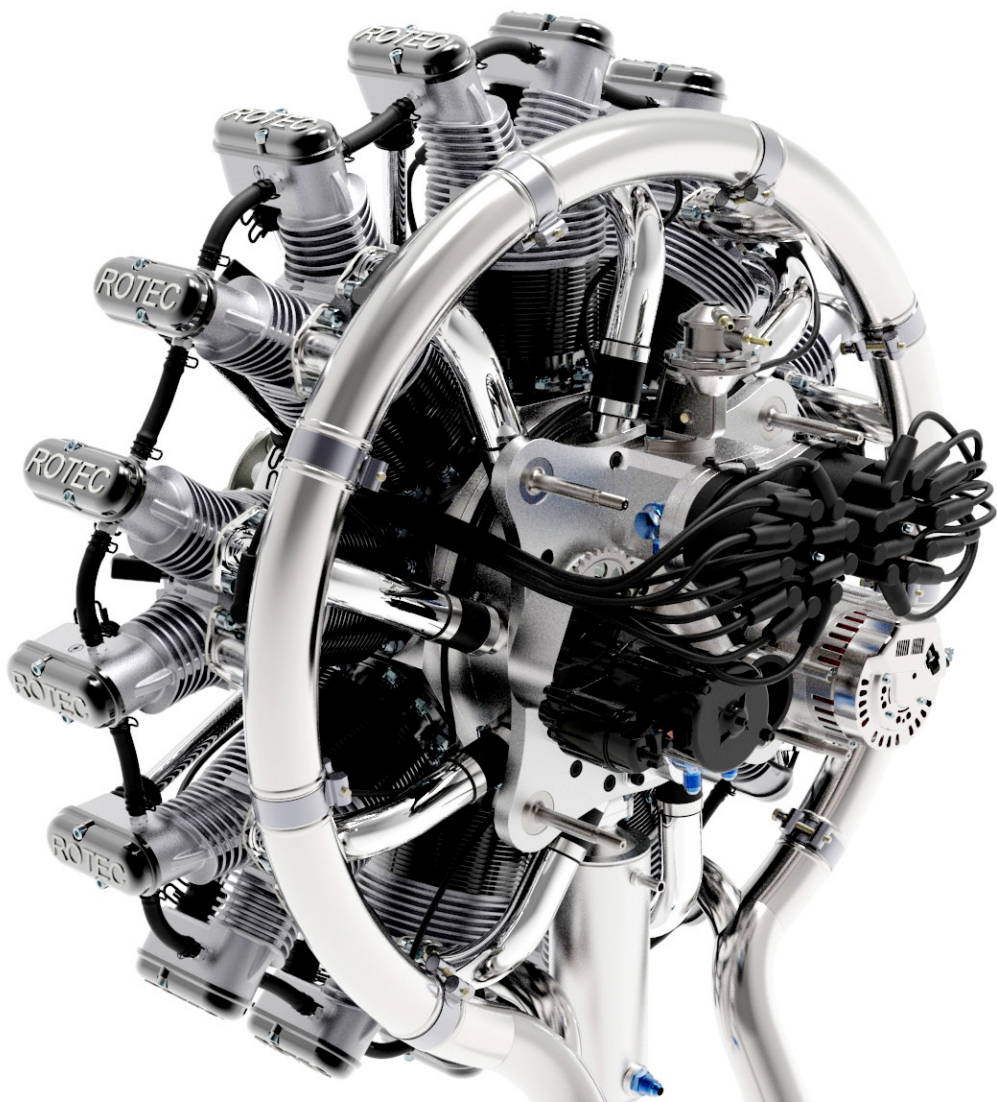

***“I get sore face muscles from  
smiling too much!”***

***- David Shaw  
Australia, 2004***

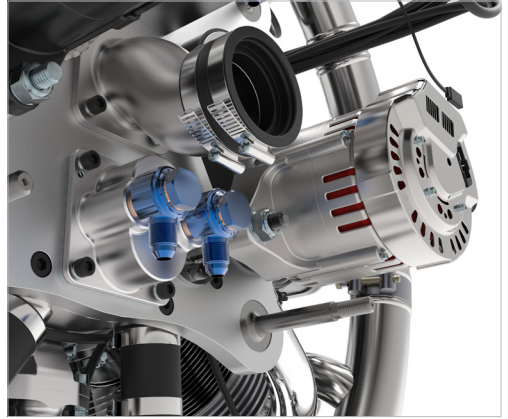
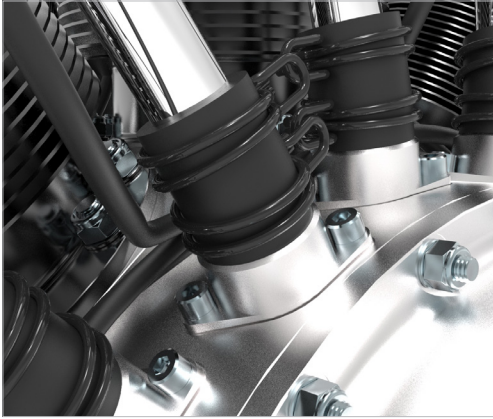

# RADIAL ENGINES ...YES YOU CAN!!!

Rotec radial engines have been developed and refined over many years to achieve the perfect balance between aesthetics, performance and reliability. The radial configuration allows for excellent air cooling, with the absence of liquid cooling the radial installation is simpler, neater and more cost effective than inline or boxer engines.

When a Rotec radial is selected for a project, it undoubtedly ensures that the end result is the best that it can be. All Rotec customer projects are visual works of art, and admired by all onlookers. The supreme sound of Rotec radials portray power and dominance. When combined with brilliant mechanical design, simple installation and high performance, it is certain that Rotec radial engines are the best choice.



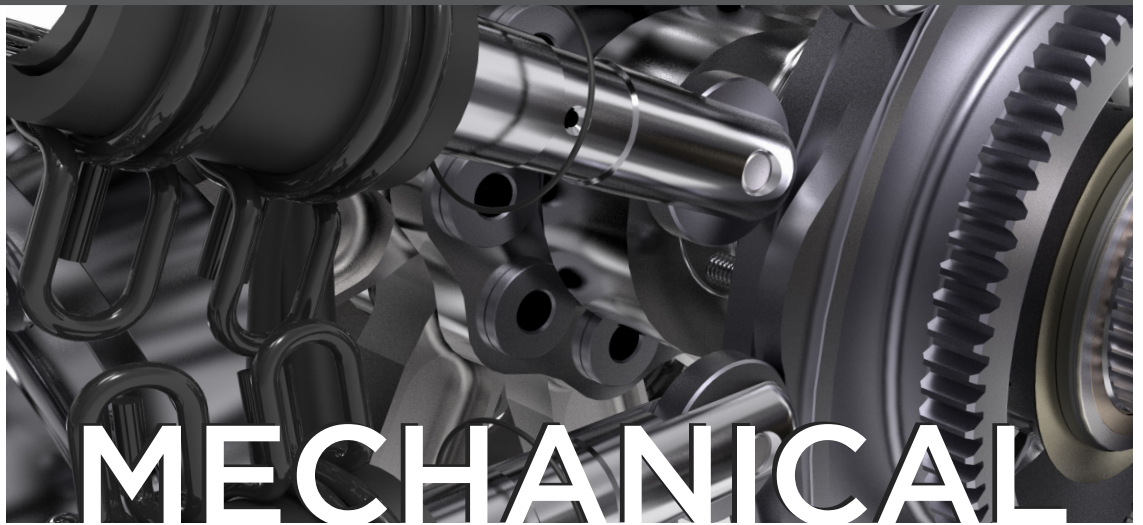

# MECHANICAL

Rotec engines are of modern design incorporating much current technology, such as electronic magnetos that never need adjusting, compact light weight starter and alternator, O-ringed rocker covers and case joints. The modern Rotec radial does not leak oil and runs smoothly. All Rotec engines come standard with a 3:2 planetary propeller speed reduction unit (PSRU). This allows for a light weight engine that punches well outside its weight division.



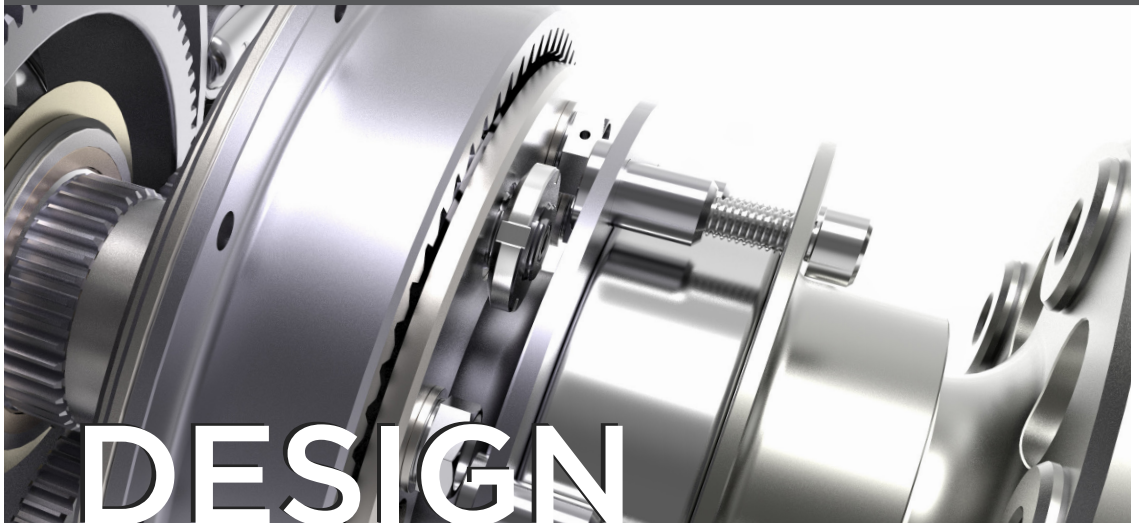

Despite the radial configuration, the Rotec radial is far from being cumbersome or outdated. Research and development is frequently conducted to continually improve the mechanical systems and design of parts and processes for the radial engines. The ongoing evolution of these motors reflect the company's passion and drive to constantly improve the overall engine efficiency and maintainability, while refining aesthetics and performance.



# AWARD WIN





A photograph of a yellow and blue Kitfox S7 Super Sport aircraft. The aircraft is shown from a low angle, highlighting its sleek, aerodynamic design. The yellow fuselage and blue accents are prominent. The cockpit area is visible, showing the canopy and internal structure. The aircraft is parked on a paved surface, and the background shows a clear blue sky and some greenery.

# WINNING

# PLANES

There have been countless award winning planes that excel in competitions due to the tremendous workmanship of the builder and the aesthetic excellence of Rotec Radial Engines.

Customers and companies collaborate with Rotec to achieve optimal results for their projects.

Rotec powered aircraft are on display at several major airshows every year, including Sun'n Fun and EAA Osh Kosh.

*Team Kitfox LLC  
Kitfox S7 Super Sport, USA  
R2800 Radial Engine*

# R2800

**7 Cyl**  
**110hp**



*“The engine runs perfectly - smooth as glass, with plenty of power. I always land with a huge grin on my face! Everyone comments on how amazing the R2800 looked and sounded!”*

*- Phil Swenson, USA, 2008*

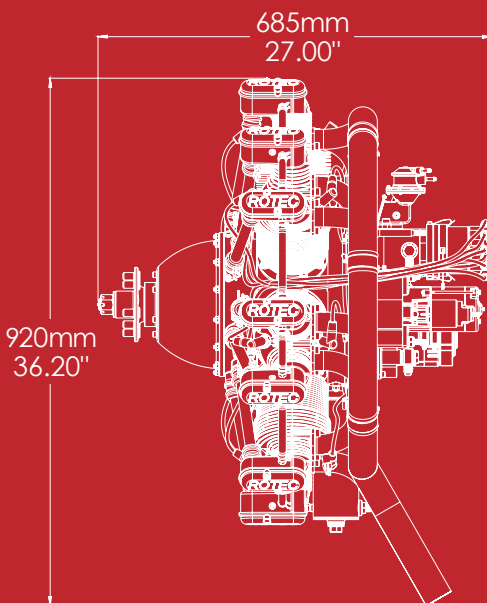
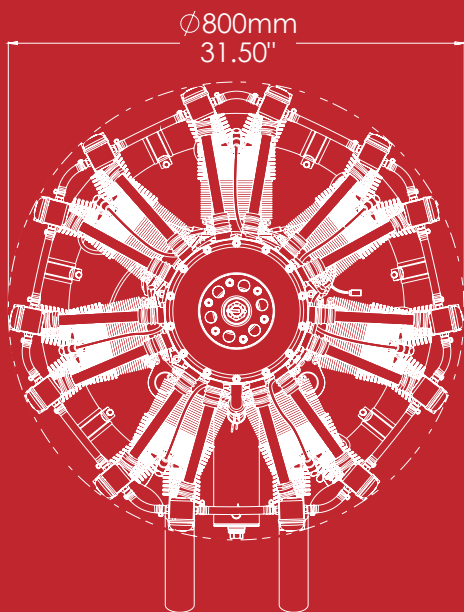

Configuration	7 Cylinder Radial Engine - Four Stroke
Capacity	2800cc (172ci)
Dry Weight	100 kg (220 lbs)
Ignition Type	Dual, Electronic and Magneto
Carburettor	TBI-40-S (or Bing Mixture Control)
Lubrication	Geared Oil Pressure & Scavenge Pump
Bore / Stroke	(3.15") 80mm x 80mm
Spark Plugs	Two per head (NGK DCPR8E)
Starter	Electric Auto Type 12V
Charging System	45 Amp Alternator
Fuel Consumption	Avgas 100LL - 22 L (5.8 gl)
Rater Power	110 hp at 2450 Prop RPM (Via 3:2 PSRU)



# R3600

**9 Cyl**  
**150hp**



*"The engine runs beautifully and flawlessly, and gets admired wherever we land! It has one difference to any old radial, it's not oily, not messy! The Rotec R3600 is a masterpiece!!!"*

*- Hans Gautschi, Switzerland, 2016*

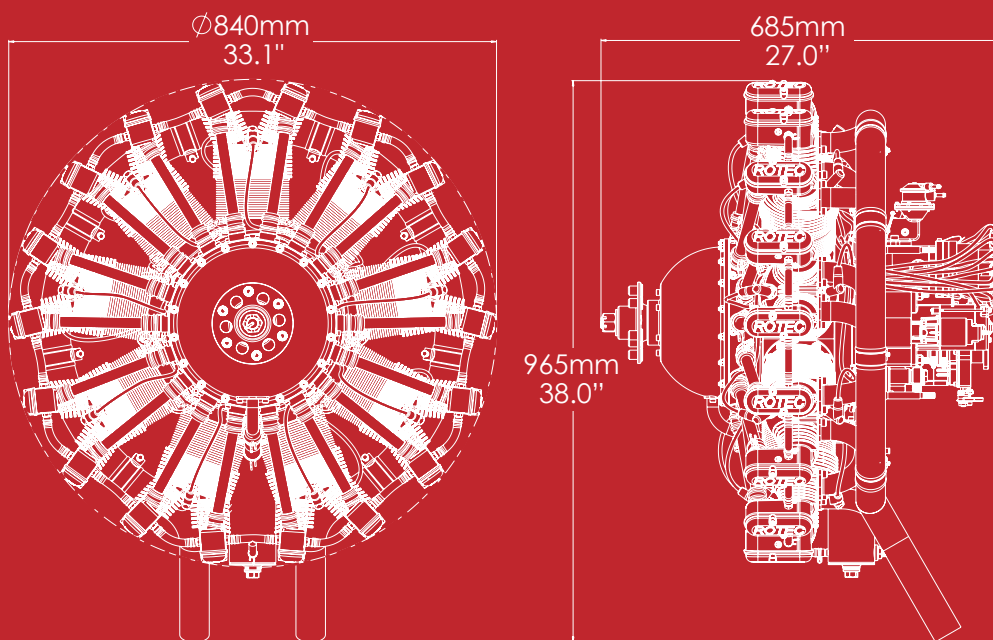

Configuration	9 Cylinder Radial Engine - Four Stroke
Capacity	3600cc (220ci)
Dry Weight	120 kg (220 lbs)
Ignition Type	Dual, Electronic and Magneto
Carburettor	TBI-40-S (or Bing Mixture Control)
Lubrication	Geared Oil Pressure & Scavenge Pump
Bore / Stroke	(3.15") 80mm x 80mm
Spark Plugs	Two per head (NGK DCPR8E)
Starter	Electric Auto Type 12V
Charging System	45 Amp Alternator
Fuel Consumption	Avgas 100LL - 22 L (5.8 gl)
Rater Power	150 hp at 2450 Prop RPM (Via 3:2 PSRU)

# DARE

Recreational pilots and aviation enthusiasts from all around the world express great admiration towards Rotec radial engines and the planes that they power.

Future aviators are encouraged to 'be different' and to make decisions that will enable their projects to avoid ordinary and achieve extraordinary.

Hundreds of lightweight planes have been fitted with Rotec radials, however there are many more out there that have the potential to achieve true excellent.

*Hans & Sam Gautschi  
Hatz Classic, Switzerland  
R3600 Radial Engine*

# TO BE D



# ...YOU WILL



**DIFFERENT**



**LL ACHIEVE EXCELLENCE**

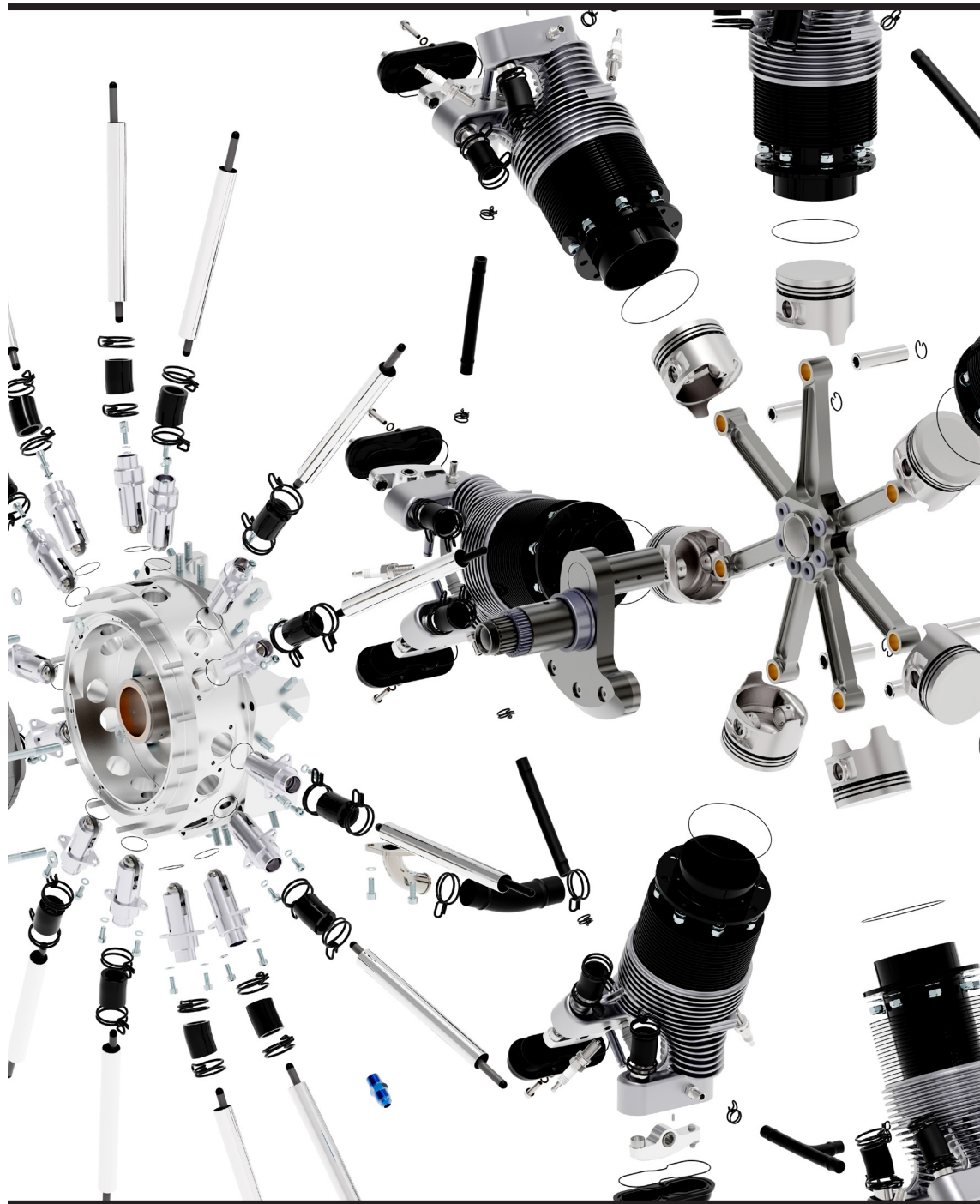



At Rotec we believe that passion and innovation propel the recreational aviation market forward. These factors are embedded in our work and our products, that result in our extraordinary customer projects that rule the skies.



*Rotec endeavour to reawaken a bygone era by allowing lightweight aeroplanes to possess the beauty, sound and power of Radial Engines.*

We want our customers to share our passion of radial powered aircraft. Contact us to make your dream a reality, and hear our current and upcoming specials. We offer firewall forward solutions that can include the following items:

- TBI Fuel System
- Exhaust Collector Ring
- Custom Engine Mount
- Custom Oil Tank
- Rocker Cover Upgrade Kit
- AFR Gauge Kit (Air-Fuel Ratio)
- Oil Scavenge Clean Kit
- Engine Service Kit
- Emergency Kit
- Rocker Pin Repair Kit
- Custom Overhaul Kit
- Performance Upgrades



## **Contact Us Today:**

Email: [Sales@RotecAerosport.com](mailto:Sales@RotecAerosport.com)

Phone: +61 3 5977 3805

Phone: 920 267 7001 (US Toll Free)

Web: [www.RotecAerosport.com](http://www.RotecAerosport.com)